



ADVENTURES IN LEARNING—Winter Session 2012

REGISTRATION: \$60—due by **January 4th**. Fees are non-refundable.

LUNCH FEE: \$8/week or \$60/eight weeks, OR bring your own lunch and get a beverage and dessert for \$3.

JOIN US!

SPRING 2012 SESSION: MARCH 22—MAY 10

~ 8:15—8:45 am ~

Coffee and Conversation in the Lobby
Blood Pressure Check in the North Hallway
 by Wichita Parish Nurse Ministry

~ 9:00—10:00 am ~

RELIGION

Jan. 10 “I Was Not Born Mennonite: Why I Am Mennonite”
 Don Steelberg, Minister, Mennonite Church

Jan. 17 “Why I Prefer Funerals to Weddings”
 Don Steelberg, Minister, Mennonite Church

Jan. 24, 31 “Jerusalem”
 Rannfrid Thelle, Adjunct Professor, Continuing Education, WSU

Feb. 7-28 “And Now the Rest of the Story...Jesus’ Parables Explained”
 Adam King, Pastor, Trinity Reformed Church

HISTORY

Jan. 10 “America’s Amusement Ride Builder”
 Jeff Roth, VP & General Counsel, Chance Rides, Inc.

Jan. 17 “Wichita’s Riverside Parks”
 Jim Mason, Wichita Parks Dept.; Naturalist, Great Plains Nature Center

Jan. 24 “Between Two Rivers—Arkansas City”
 Terry Naden, Teacher, Retired

Jan. 31 “Leeches, Japanese & Other Enemies in WWII”
 Loren Corliss, Attorney, Koch, Oil & Gas Leases, Retired

Feb. 7 “Unsinkable Molly Brown”
 Ardellee Coans, U.S. Govt. Census Bureau, Dept. of Commerce, Retired

Feb. 14 “What We Saw and What We Heard—History of Film and Recorded Music”
 Racine Zackula, Librarian, Art, Music & Video Dept., Wichita Public Library

Feb. 21 “*The Stories the Soldiers Wouldn’t Tell*” by Lowry—Civil War
 H.W. Collier, Anesthesiologist, Docent/Volunteer, Wichita Sedgwick Co. Historical Museum

Feb. 28 “Designs of Wichita”
 John Richardson, Docent/Volunteer, Wichita Sedgwick Co. Historical Museum

~ 9:00—10:00 am ~

POTPOURRI

Jan. 10 “Point & Counterpoint: Part 2—The ‘Dueling Lawyers’ Return”
 Boyd McPherson, Attorney at Law, Joseph & Hollander, LLC
 Jess Hoeme, Attorney at Law, Joseph & Hollander, LLC

Jan. 17 “Exploring the Paranormal”
 Claire Nichols, Team Leader & Case Mgr., Everyday-Legacy Paranormal
 Jason Roberts, Wichita Ghost Tour Guide

Jan. 24 “Part Two: Taking the ‘Technical’ Out of Technology —A Primer for Seniors”
 Doris Anton, Program Specialist, TRIO Educational Opportunities Center Program, WSU

Jan. 31 “Let’s Talk Mysteries”
 Cindy Bailey, Manager, General Reference Dept., Wichita Public Library
 Katie Menon, Librarian, Wichita Public Library

Feb. 7 “Floral Designs That You Can Create”
 Sara Jones, Former Floral Designer, Shop Owner and Manager

Feb. 14 “Consumer Fraud”
 Sharon Werner, Chief Attorney, Consumer Fraud Division, District Attorney’s Office

Feb. 21 “Taking a Peek at Photoshop—Turning Your Photos into Art”
 Paulette Mattingly, Owner, Custom Banners; Office Mgr. & Asst. Funeral Director, Hillside Funeral Home; Retired

Feb. 28 “The Story of Dr. John R. Brinkley—KS Goat Gland Doctor & Border Blaster Radio Charlatan Huckster”
 Don Thomas, Mfg. Engineer, Boeing, Retired

~ 10:15—11:15 am ~

TAI CHI (LIMIT 16)

Jan. 10—Feb. 28 “Balance and Harmony”
 Cost: registration fee plus \$2 paid each week at class
 David Larsen, Instructor, Advocates for Active Aging

~ 10:15—11:15 am ~

HEALTH

- Jan. 10** “Alzheimers? Knowing the 10 Signs”
Jenny Shipman, Program Director, Alzheimers Assoc.—Central and Western Kansas
- Jan. 17** “Personal Health and Safety: Nutrition and Technology”
Amy Maxton, Community Outreach Liaison, Home Technology Solutions
Dr. Timothy Clark, Lifestyle Consultant, Weight Loss Coach
- Jan. 24** “Not Ready to Leave Your Home?”
Shana Gatschet, Occupational Therapist & Accessibility Consultant, Adaptive Living
- Jan. 31** “Home Safety Solutions”
Shana Gatschet, Occupational Therapist & Accessibility Consultant, Adaptive Living
Robert Schmidt, Hart Pharmacy & Medical Equipment
- Feb. 7** “United Way 2-1-1”
Heather Pierce, Coordinator, 2-1-1 Call Center
- Feb. 14** “Hoarding: The Impact of Compulsive Keepers”
Denise Diaz, Extension Agent—Family and Consumer Sciences, Sedgwick Co. Extension Office
- Feb. 21** “The Leukemia and Lymphoma Society: Dedicated to Helping Blood Cancer Patients”
Christy Thomas, Medical Social Worker and Patient Services Mgr., Leukemia and Lymphoma Society
- Feb. 28** “Infinite Growth Opportunities”
Susan Schoket, Director, Infinite Growth Opportunities—Improving physical and mental health through gardening and growing food; Teacher, Social Worker

THREADBARE READERS THEATRE

- Jan. 10—Feb. 28** Join a fun group rehearsing short skits and sketches for public presentations. No memorization is needed but good public reading/speaking is important.
Ed Thompson, Drama Teacher, Retired

TRAVEL

- Jan. 10** “A Part of Kansas History”
Esther Kanady, KS Lover, Kindergarten Teacher, Retired
- Jan. 17** “Facts, Myths and Opinions about Foreign Travel: Pictures, Comments and Discussion”
Cliff Winter, Pastor, Retired
Lois Winter, Retired; Both Experienced Tour Leaders
- Jan. 24** “Amsterdam, Scotland and Northern Ireland”
Susan Winn, Structural Designer/Artist, Retired
- Jan. 31** “The Boat Ride to...”
Linda Hoobler, USD 259/Wichita, First Mate/Admiral of Tumbleweed, Retired
Floyd Walpole, Wichita Police Dept.; Owner, Wilco, Inc.; Captain of Tumbleweed; Retired
- Feb. 7** “Enchanted Europe: Eight Countries”
Karen Malcom, RN, MSN, CNS, Retired
Pat DeVoss, RN, BSN, Retired

~ 10:15—11:15 am ~

- Feb. 14** “The Wonders of Africa”
John Frye, CEO, Starkey School, Retired
- Feb. 21** “Albuquerque Balloon Fiesta”
Richard Hitchcock, Planner, Cessna Mfg., Retired
- Feb. 28** “Boating Adventures”
Linda Hoobler, First Mate/Admiral of Tumbleweed, Retired
Floyd Walpole, Captain of Tumbleweed; Retired

POETRY

- Jan. 10-Feb. 28** “Read Poetry to Write Poetry”
Roy Beckemeyer, Ph.D., Aeronautical Engineer, Retired

PHILOSOPHY / ETHICS

- “What is Truth? A Framework for Analyzing Current Issues” Part 1 *see p. 4 for an extensive description*
- Jan. 10** *Class begins next week*
- Jan. 17** “Introduction to the Concept of Truth” and “Tools to Approach Truth”
- Jan. 24** “Life Issues, Medical Issues, Health Issues”
- Jan. 31** “Abortion, Euthanasia, Stem Cell Research”
- Feb. 7** “Marriage, Adultery, Sexual Issues”
- Feb. 14** “Private Property”
- Feb. 21** “Finances, Capitalism”
- Feb. 28** “Social Welfare, Taxes, Gambling”
Lionel Alford, Jr., Ph.D., Author, Aviator, Engineering Consultant, Educator

~ 11:30—12:30 Luncheon

12:30—1:00 pm Program ~

- Jan. 10** “Music with a Higher Purpose”
Cassidy Cheray, Band Director, Holy Cross Lutheran
Cindy Franson, Choir Director, Holy Cross Lutheran School
Forty Musical Students
- Jan. 17** “Ghost Be Gone—Understanding Ghosts and the Paranormal”
Beth Cooper, Author, Speaker, Radio Host, Historian
- Jan. 24** “Kansas Ghost Towns”
Ken Spurgeon, Teacher, Filmmaker
- Jan. 31** “Tunes to Love”
Ardith Simmons, Pianist, Teacher, Retired
- Feb. 7** “Tuskegee Airmen, Inc.”
George Mills Boyd, Class 45-G TAAFI; Colonel Civil Air Patrol; Major, USAF; Retired
- Feb. 14** “Songs of the Heart Per Decade”
Olivia Jade Camerena, Singer, Student
- Feb. 21** “The Winners! Let Them Talk For You”
Vickie Fellers, Debate Coach/Forensics, Wichita East High School
- Feb. 28** “Belly Dance for Fun and Fitness: Why I Shimmy”
Jill Rust, Speech and Language Pathologist, Fibromyalgia Sufferer, Belly Dancer

~ 1:15—2:15 pm ~

CREATIVE WRITING

Jan. 10—Feb. 28 “Creative Writing...Not Listening”
Nancy Avery, English Teacher, Feature Writer, Text-
book Author, Retired

WHAT HAVE YOU READ LATELY?

- Jan. 10** “Geniuses of the Arts”
Racine Zackula, Librarian, Art, Music & Video Dept.,
Wichita Public Library
- Jan. 17** “Genius: Thomas Edison”
Brad Purkey, Community Relations Mgr., Barnes &
Noble—Bradley Fair
- Jan. 24** “Reading in the Electronic Age”
Joshua Sturgill, Book Seller, Eighth Day Books
- Jan. 31** “Boil & Bubble: Amazon Women of Kansas”
James D. Yoder, Professor, Psychologist, Retired
- Feb. 7** “*Destiny of the Republic: A Tale of Madness,*
Medicine and the Murder of a President”
Bonnie Thompson, R.N., Nursing Administrator, Retired
- Feb. 14** “Line-Up of New Books”
Sarah Bagby, Owner, Watermark Books
- Feb. 21** “*Life of Pi* by Martel: A Boy, a Boat and a
Bengal Tiger Adrift on the Pacific”
Katie Funk Wiebe, Author, English Professor Emeri-
tus, Tabor College
- Feb. 28** “*Unbroken: A WWII Story of Survival, Resil-*
ience and Redemption by Laura Hillenbrand”
Marcia Newton, Educator/Accountant, Retired

PERSONAL STORIES

- Jan. 10** “Chocolate Pleasures”
Beth Tully, Owner/Master Chocolatier, Cocoa Dolce
Artisan Chocolates
- Jan. 17** “A Big Life”
Bonnie Bing, Fashion Editor, *The Wichita Eagle*
- Jan. 24** “Where the Wild Things Are”
Schanee Anderson, Curator of Education, Sedgwick
County Zoo
- Jan. 31** “Use Your Time Wisely”
Marlin Brown, Coordinator, Volunteers in Mission
- Feb. 7** “My Aunt’s 11 Years in Siberian Forced Labor”
Katie Funk Wiebe, Author, English Professor Emeri-
tus, Tabor College
- Feb. 14** “Tai Chi: Wandering Along the Way”
David Larsen, Tai Chi Instructor
- Feb. 21** “How Kansas Won”
Susan Howell, Mathematician, Technical Director,
The Wichita Eagle; Retired
- Feb. 28** “And the Rest of My Story...”
John Frye, CEO, Starkey, Retired

~ 1:15—2:30 pm ~

ARTS, CRAFTS & HOBBIES (Limit 16)

Jan. 10—Feb. 28 “Working on Your Individual
Project—with a Group!”
Come enjoy fellowship while doing your own piece or
project that you bring. Open class time for all.
(*Painting: please no turps or mineral spirits.*)



Adventures in Learning is an opportunity
for active adults. We offer classes on a wide
variety of subjects and activities.

You may attend *as many classes as you
like* in those eight weeks for one session’s
registration fee!

The classes are held at **East Heights
United Methodist Church** (handicap acces-
sible) on Tuesdays, 9:00 am—3:00 pm.

Class size may be limited according to
type of class or room size.

The Winter Session runs **January 10—
February 28.**

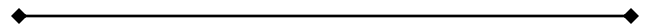

PIANO

Ms. Ezma Maust is our long-time piano instructor
and member. She is taking a break
from the ivories during this session.
Don’t worry though—she’ll be back
teaching in the Spring Session.
We appreciate her!

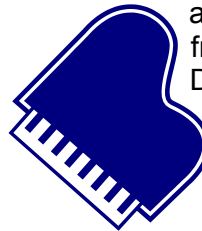

WELCOME

LifeVentures welcomes guests. You may bring a
friend (*first-time attendee only*) to classes one
Tuesday with no fee. Lunch would need to be
purchased, however. To make arrangements to do
so, please contact Stacy in the office at 682-0504.

MENU

We offer a buffet-style hot lunch with entertainment.

Lunch reservations need to be made by Friday noon.
(If you are bringing your own lunch, please call to reserve a seat.)

January 10

Beef Lasagna
Steamed Broccoli Flowerets
Caesar Salad, Garlic and Herbs Bread
Fruit Cobbler

January 17

Chicken Marsala
Orzo Pasta, Prince Edward Vegetables
Waldorf Salad, Wheat Roll
Chocolate Brownie

January 24

Chicken Fried Steak with Gravy
Cheesy Potatoes, Peas with Garlic Butter
Jello Salad, Dinner Roll
Cookie

January 31

Meatloaf
Scalloped Potatoes, Corn
Cole Slaw, Biscuits
Banana Cake

February 7

Chicken and Turkey Tetrazzini
Buttered Beets
Spinach Salad, Dinner Roll
Bread Pudding

February 14

BBQ Brisket
Sweet Potato Casserole, Green Beans Almondine
Garden Vegetable Salad, Dinner Roll
Strawberry Shortcake

February 21

Chicken Alfredo
Pesto Pasta, Orange-glazed Carrots
Italian Tossed Salad, Bread Sticks
Cheese Cake

February 28

Smothered Steak
Garlic Mashed Potatoes, Steamed Vegetables
California Spring Mix, Corn Bread
Carrot Cake



Do you know about your LifeVentures staff members?

Stacy Jansson is the Executive Director, Gwen Hillis is Volunteer Coordinator and Connilee Myers is Administrative Assistant. All three ladies work part-time, with someone always being available any day of the work week. The office helps coordinate the many, many volunteers and committees that make LifeVentures work!

You spoke—We listened: The Luncheon Program will be slightly shorter. Our presenter/entertainment will have from 12:30—1 pm for the program. Afternoon classes will start at 1:15 pm. After we try this a few times you are welcome to give us some feedback.

What is Truth?

Dr. Lionel Alford is departing from his ancient history format to focus on current issues in a two-session class—Part 1 in the winter session and Part 2 in the spring.

Complex issues in the modern world pose a dilemma for many. Chief among them is what basis should we use for making decisions.

Because there are broader and more complex questions awaiting us in the near future, what should drive our decision-making process? What science should we support such as cloning, abortion, euthanasia, stem cell research, environmental issues? How should we approach critical life decisions such as marriage, sexuality, forgiveness, work, honoring parents, protecting ourselves and others?

These questions are more timeless than we sometimes think. Some of them have been answered directly, and the answers to others are easily discernable. This class will evaluate these issues in terms of what we can prove to be true. It will define what is provable and what is not, within the framework of human understanding. We will not answer every question, but the class will provide tools to evaluate any question.

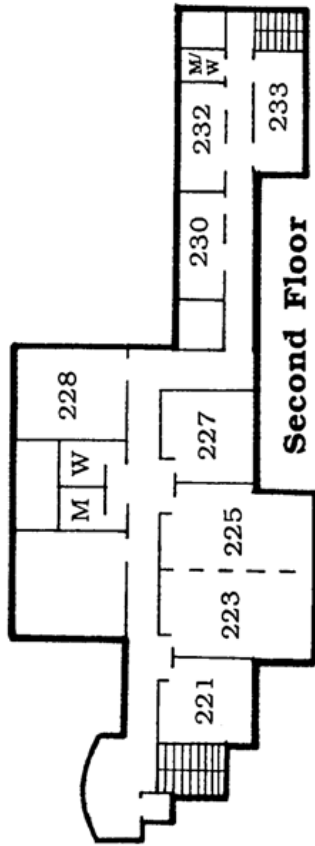
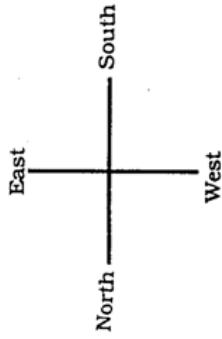

Second Floor

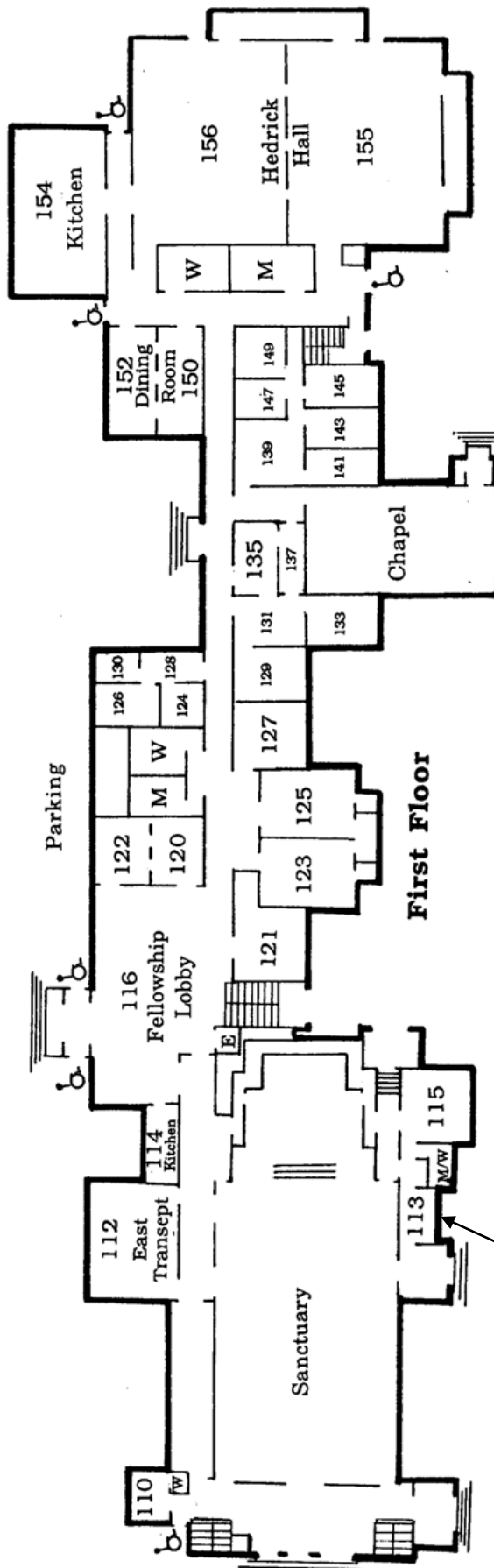

First Floor

Important Information for Inclement Weather
 If weather is inclement, listen to radio and television reports. If the Wichita Public School classes are cancelled, *Adventures in Learning* classes will be cancelled also.

Parking is available on the east and south sides of East Heights United Methodist Church, the east side of Crestway Street, the parking lot of Second Church of Christ Scientist (east of East Heights).

The "no parking" area on the east side of the church is reserved for people taking young children to preschool. We have a security guard on duty for the safety of all.

LifeVentures Office

Flourish with Adventures in Learning!



LifeVentures

Your place to keep knowing & growing

4407 East Douglas Wichita, KS 67218 682.0504

Adventures in Learning



Winter 2012 Schedule:

January 10—February 28

Return Postage Requested

Non-Profit Org.
U.S. Postage Paid
Wichita, KS
Permit No. 293

LifeVentures

What is it?

We are a non-profit, interfaith community of adults. LifeVentures is a member of Shepherd's Centers of America.

What is our Mission?

To provide educational and enrichment opportunities for adults in an interfaith environment.

What are our Services?

Adventures in Learning (education) and social outings

Who does the work?

Volunteers and the office staff

How is it financed?

By donations, memorials, and *Adventures in Learning* fees

Where is it located?

East Heights United Methodist Church, 4407 East Douglas, Wichita, KS 67218

We are blessed to have the support of these congregations:

East Heights United Methodist ~ Hillside Christian ~ Holy Cross Lutheran ~ Lorraine Avenue Mennonite
Grace Presbyterian ~ Temple Emanu-El ~ University Congregational ~ College Hill United Methodist
University United Methodist ~ St. James Episcopal ~ First United Methodist ~ Plymouth Congregational

For more information, call the LifeVentures office at (316) 682-0504 between 9 am and 3 pm Mon—Thur.

www.LifeVenturesKS.com



Like us on facebook